

# REAR LATERAL CONTROL ROD

## COMPONENTS

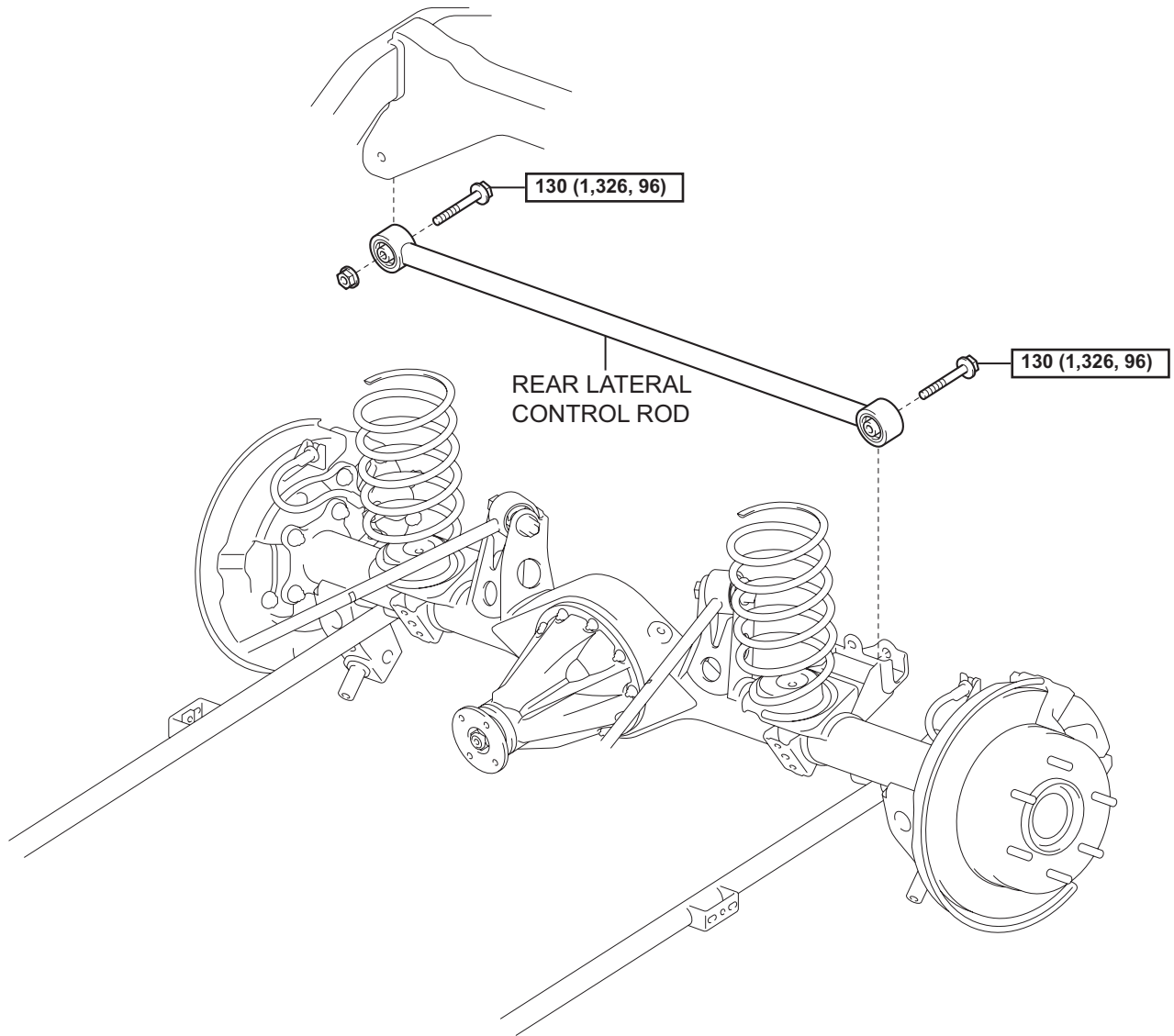

SP

$\text{N}\cdot\text{m}$  (kgf $\cdot$ cm, ft $\cdot$ lbf) : Specified torque

## REMOVAL

### 1. REMOVE REAR LATERAL CONTROL ROD

- (a) Support the rear axle housing.
- (b) Remove the bolt.

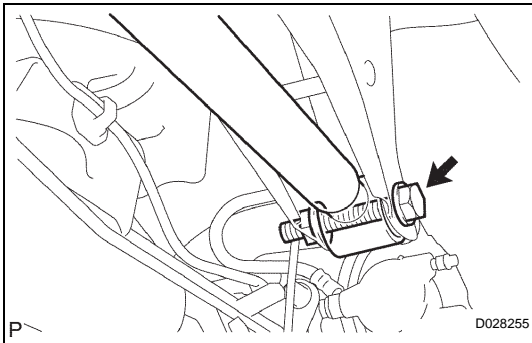
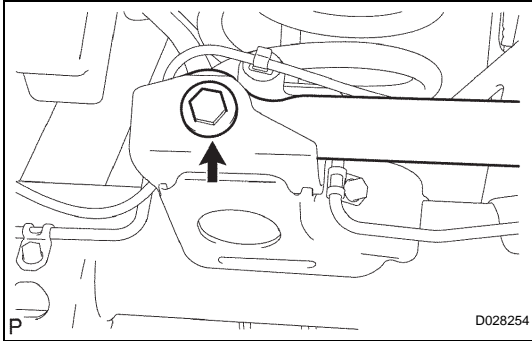

- (c) Remove the bolt and nut and remove the lateral control rod.

#### HINT:

While fixing the nut, turn and remove the bolt.

## INSTALLATION

### 1. TEMPORARILY TIGHTEN REAR LATERAL CONTROL ROD

- (a) Install the lateral control rod and provisionally tighten the bolt.

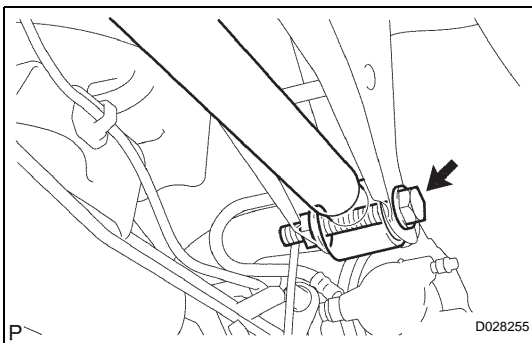
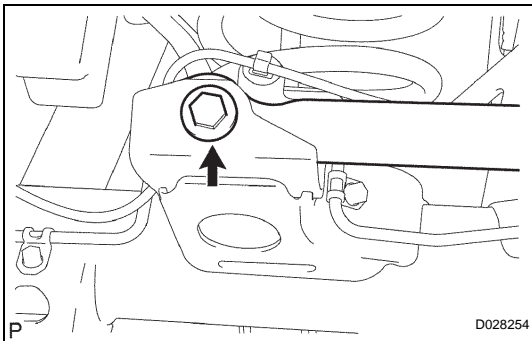

- (b) Provisionally tighten the bolt and nut.

### 2. STABILIZE SUSPENSION

- (a) Jack down the vehicle.
- (b) Bounce the vehicle up and down several times to stabilize the suspension.

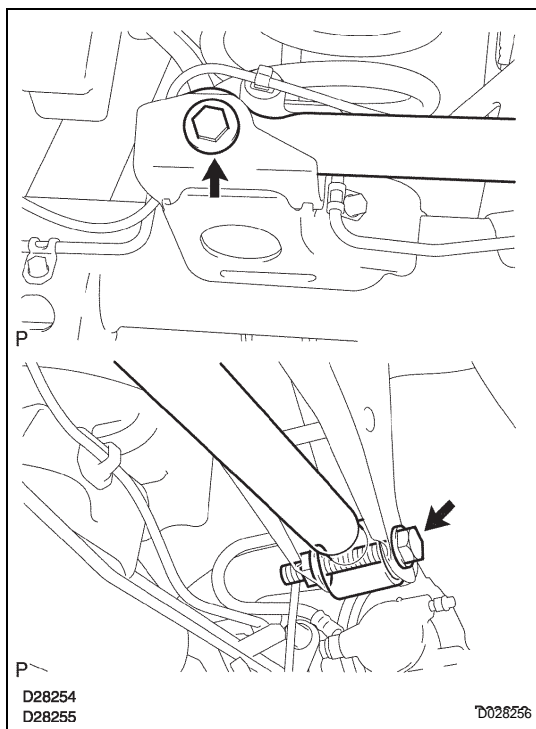
**3. FULLY TIGHTEN REAR LATERAL CONTROL ROD**

(a) Fully tighten the 2 bolts.

**Torque: 130 N\*m (1,326 kgf\*cm, 96 ft.\*lbf)**

**HINT:**

While fixing the nut, turn and install the bolt.